



# WE GO GARDENING

## Newsletter of the West Chicago Garden Club

Volume 8 Issue 6 June 2005

### Inside this issue

Upcoming Events (Outside the Club)	2
Calendar of Events 2005	3
ASK Our Gardeners	4
Kruse House	5
Water Tips	6

### May Program – Micro Irrigation/ Drip Watering by Pamela Darrah

At the May meeting we met in the Kruse House garden and Pamela Darrah provided an overview of the watering system we use there. The Club installed a drip-watering system at the garden three years ago. Since the system is automated, it takes less volunteer time to keep the garden watered. The Drip system was chosen (also called Micro Irrigation) for a number of reasons:

- It is fairly easy to install, so we could do it ourselves.
- It isn't too expensive—the entire project cost around \$500 for six garden zones.
- It is reasonably durable—the hoses and sprayers can be in the garden all winter.

The main negative for a drip system is that it usually requires more maintenance than a professionally installed in-ground system. The tubing can be accidentally cut and the

sprayers and drippers can get closed. We have had a good record at Kruse Garden, no tubing problems and only a couple clogged sprayers. The cost of replacing these is \$1-2 each, which we did. This year, a valve failed, but that is an in-ground part that could fail on any system.

The Kruse Garden system is more complex than you might use at your home, since we wanted it to be completely automated. We have electronically operated valves that are wired to a timer. We also had to trench the lawn and put in PVC pipe out to each zone, since the garden is so large.

The drip watering system we use at Kruse Garden is made by RAINDRIP (a division of NDS). To find out more about these systems, go to their website:

[www.raindrip.com](http://www.raindrip.com). If this sounds like something that would help your garden, see the opportunity to buy at a discount on the next page.

### June Program—Diane Hunter on Japanese Gardens

When: **Thursday, June 23** at the First Congregational Church on Route 59.

#### Meeting Schedule

6:45– 7:15 Time for Sharing, Visiting and Refreshment

7:15—Business meeting

7:30— Program on Japanese Gardens. This program is a prelude to the Club field trip to the Klehm Arboretum and Anderson Japanese Gardens on June 25.

## Upcoming events (outside the club)

**Do-it-right Series— The Growing Place, Aurora.** Saturday, **July 16** 9:30 am (Free) "Grow It Right—Summer Color Selections." Saturday, **July 30** 9:30 am (Free) "Design It Right—How to plan structure plantings." **Gardener Art Series Friday, July 29 (at Naperville location).** 9:30 am "Make a hypertufa trough" **July 1-6** Red, White and Blue Sale—15% off anything that blooms Red, White or Blue

**Platt Hill Seminars:** Sat., **June 4** 10am "Hummingbird & Butterfly Gardening; Sat., **June 11** 10am "Ornamental Grasses"; Sat., **June 18** 10 am "Rose Care"; Sat., **June 25** 10am "Planting & Pruning Trees & Shrubs"

**Morton Arboretum—May 21– August 21** "Live on the Hedge" the new maze garden. Visit the web site [www.mortonarb.org](http://www.mortonarb.org) for a full listing of all the many programs and events that are scheduled from container gardens to theatre hikes.

### PLANT SALE

### ATTENDEES

This is 2nd and last free issue of the newsletter.

Please consider joining the Club. We want to get to know you and share gardening ideas with you.

Membership is only \$15 for an individual or \$25 for a family.

**Club Members:** Dick and Pamela will be purchasing parts from RAINDRIP for their own gardens. Since their order is over \$300, they will be getting a 30% discount. If other Club members would like to place an order, we can pool them together so everyone can get the discount.

If you are interested, call Dick or Pamela at 584-1900 or email them at [pdarrah@sprynet.com](mailto:pdarrah@sprynet.com). The order is going in on Friday, June 24th, so let them know right away if you are interested.

Flowers are not made by singing

"Oh, how beautiful," and sitting in the shade.

-Rudyard Kipling

You're invited to come explore, get inspired, learn and add some beauty to your garden at

**HEINZ BROTHERS**  
Greenhouse Garden Center

2010 East Main St. (Rt. 64), St. Charles  
630.377.6288 [www.HeinzBrothers.com](http://www.HeinzBrothers.com)

Your Gardening Source....

**True Value.**  
Help Is Just Around The Corner.

103 W. Washington St  
West Chicago, IL 60185  
630-231-3813

**Just Ask**  
RENTAL  
at True Value.

Rototiller \$22  
2 hour min

**TOP SOIL**  
99¢

EXPIRES 5/31/05  
w/coupon

Winfield Road at the  
Railroad Tracks  
Winfield

**WINFIELD**  
fuel & material  
665-1144 \*\*\*\*\*

665-1144

**Do It Yourself Center**

**Paving, Terracing & Edging Materials**

- Concrete Retaining Wall Systems • Landscaping Timbers

**Decorative Gravel**

- Shredded Cedar or Cypress Mulch • Limestone Chips • Heritage Pebbles
- Meramec Gravel • Sand Pebbles • Red Lava • Western Sunset
- Burnt Coral • Red Flint • Red Granite

## Club information

West Chicago Garden Club  
P. O. Box 313  
West Chicago, IL 60186

(630) 585-4005

www.bwdarrah.com/wcgarden

### Membership information

Dues for 2005:

Individual: \$15

Family: \$25

### 2005 board

President:

Linda Harlson (630) 293-1057  
ashengal@prodigy.net

Vice President:

Billie Childress (630) 231-1791  
billiec@covad.net

Treasurer:

John Warbiany (630) 293-5795  
Fax: (630) 293-5794

Secretary

Angie Sadauskas (630) 231-5851

Information Director

Edie Streams (630) 231-4821  
westreams@hotmail.com

Plant Sale Chair

Dick Darrah (630) 584-1900  
info@bwdarrah.com

Garden Walk Chairs

Lou Horton (630) 293-7735  
Sam Childress (630) 231-1791

Madeleine Bartsch (porch chair)  
(630) 231-3217

## Calendar of events 2005

Date	Speaker	Topic
June 23	Diane Hunter	Japanese Gardens
June 25	FIELD TRIP	Anderson Japanese Gardens Klehm Arboretum—Rockford
July 28		President's Potluck and making Japanese Lanterns (at Billie's)
August 25	Connie and Carole	Making Decorative Concrete Leaves (at Carole's)
September 22	Nancy Carroll	Fall Interest in the Garden
October 27	Sandy Klausman	Spring Bulbs
November 17		Potluck and Elections

### Reminders

**Babysitting**—The Club provides babysitting during its regular monthly meetings when held at First Congregational Church. There is no fee to us the service, but if you plan to use it, please **call Linda Harlson** at 293-1057, so we can plan for the right number of children .

**Guests and Visitors are always welcome.** Members are encouraged to bring a friend or neighbor. If you came to our plant sale, you might want to see what great programs we have and how much you can learn from Club members.

**Field Trip**—If you want to go on the field trip to Klehm Arboretum, call Linda Harlson (293-1057) right away to see if there are still any places still open for the trip.



1055 W. Washington St.  
West Chicago, IL 60185

-Annuals & Perennials -Vegetables -Hanging Baskets  
-Poinsettias -Mums & Kale -Balsam Reindeer

phone: 630-293-0100 fax: 630-293-1510



MEYER  
LANDSCAPING, INC.

Nursery · Landscaping Design & Construction

27 W 067 North Avenue  
West Chicago, Illinois 60185

630-293-4800  
Fax: 630-293-4797

# ASK our Gardeners

**ASK** would like to share ideas for gardeners to visit in other areas. Contact Edie Streams with gardens to visit from "away". There will be a sheet you can sign at the next meeting to suggest gardens to visit.

**Q** What gardens have Club members visited from outside the Chicagoland area?

- A**
- Cheekwood Botanical Garden and Museum of Art in Nashville, Tennes-

see Many specialized gardens including a Japanese Garden, and a Wild-flower Garden. [Www.cheekwood.org](http://www.cheekwood.org)

- Longwood Gardens—Kennett Square, PA. Pierre DuPont's gardens. Wonderful fountains and beautiful gardens. [Www.longwoodgardens.org](http://www.longwoodgardens.org).
- Olbrich Botanical Gardens close by in Madison, Wisconsin—award winning rose garden. [Www.olbrich.org](http://www.olbrich.org)

## NEEDED

### Coffee Cans

Or other large metal cans with lids.

Bring them to the meeting or contact

Billie Childress.

These will be used to make Japanese Lanterns at the July meeting.

**MYSTERY PLANT**—Can anyone identify the plant to the right? This mystery plant with pinkish flowers is growing at the Kruse House and has stumped some of our best gardeners!



## Barn Owl Feed and Garden Center

1N583 Gary Ave., Carol Stream  
 (630) 668-0316  
 Hours: M-F 8 to 6 Sat 9 to 4  
 Full line of garden tools, annuals and perennials, pet food and supplies, birdseed, statuary, propane and more!

### 2005 Gardening Season Special Features

- Endless Summer Hydrangea
- Mango Meadowbrite Echinacea
- Orange Meadowbrite Echinacea
- Rosa Knockout
- Rosa Double Knockout
- Cotoneaster Nordic Carpet
- Huge Selection of One Gallon Perennials
- 10% Off your Plant Purchase with this Ad

## 80 Years & Still Growing

- \* Over 160 Acres of Fine Nursery Stock
- \* A Complete 7 Acre Retail Garden Center
- \* Landscape Design and Installation



Since 1925...the only name you need to know

**WASCO  
 NURSERY  
 & GARDEN CENTER**

**630-584-4424**

6 miles west of  
 Randall Rd. on Rt. 64  
 1 mile west of Wasco  
[www.wasconursery.com](http://www.wasconursery.com)

## Kruse House Update

by Dan Bebee

Great progress has been made at the Kruse House garden this year. We have started receiving compliments on how great the beds are looking. A large number of beds have been adopted (see layout of beds below). There are still a few beds looking for sponsors. If you can, please consider adopting a bed and putting in a few hours in the garden. You can always co-adopt a bed with someone else.

We will be ordering mulch for delivery in July (some of where our plant sale earnings go). We will need all the help we can get to load, haul and spread mulch around the garden on Saturday, July 23 from 8 am to noon. Water and snacks will be available and we will be grilling hot dogs and burgers in the garden at noon for all those who turn out! Plan on attending this event—it's a great way to meet and socialize with other club members. Non-members are welcome to help too!

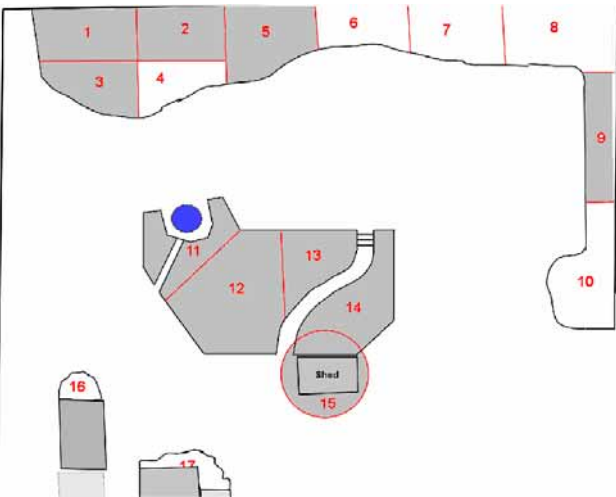

White areas need a volunteer! #4 has been adopted



Billie Childress attacking weeds



**KRAMER TREE SPECIALISTS, INC.**  
Complete Professional Tree Care  
701 Church Street  
West Chicago, Illinois 60185

**(630) 293-5444**  
**FAX (630) 293-7667**

[www.kramertree.com](http://www.kramertree.com)

## KRUSE HOUSE

### Mulching Work Dates

Saturday July 23 (8-12) and Sunday August 7 (1-4)

**FELTES FAMILY** (630) 231-3859



Spring Bedding Plants, Fruits & Vegetables, Fall Festival, Christmas Trees  
29 West 310 North Ave., West Chicago, IL 60185  
Hours: 9:00 AM—Dusk

• **SHADY • HILL • GARDENS •**

BATAVIA and ELBURN



• **GERANIUM • SPECIALISTS •**

(630) 879-5665 [www.shadyhill.com](http://www.shadyhill.com)

## Watering Tips from The Growing Place

### Guidelines to help your plants thrive and be more resistant to dry periods

You need to water slowly and deeply. Deeply watered roots will grow deeper.

You also need to let the ground dry briefly between watering. Your plant's roots also need air circulation in the soil.

### For gardens

Sprinklers should run 3-4 hours to equal a rain shower. You can test how much water your garden receives by using a tuna can as a rain gauge. If you have mulch over your beds, the water will need to get through to the soil. You need to touch the soil down to a depth of 1" to ensure that the soil is actually getting moisture. Use a low sprinkler, not a fan sprinkler, they lose too much water to evaporation. SOAKER HOSES are efficient. Use a portable 10' section that can easily be moved or place longer sections throughout the garden evenly.

**Newly planted perennials and annuals** will need more water. Always water the day of planting. Follow general guidelines and spot water. KNOW THE PLANT'S MOISTURE NEEDS. Some plants need more water than others.

**Newly planted perennials and annuals** may need shade for a few days if they are wilting. Use a lawn chair or umbrella to shade it temporarily.

### For trees and shrubs

**Newly planted trees and shrubs** should be watered the day of planting. Use a slow trickle from a hose rotated around the base of the plant OR create a temporary soil ridge around the circumference of the plant that will hold water. Fill it 2-3 times. Remove the ridge after about two weeks. ALWAYS WAIT UNTIL THE GROUND HAS DRIED OUT before watering again. Test for soil moisture by putting your finger into the soil about 2 inches.

Established trees and shrubs need extra moisture in periods of no rain. Damage to them will not show up for 1-3 years after dry periods! A root feeder without the fertilizer will allow water to get to the roots. Insert into soil in varying spots every few days when there hasn't been rain for 2 weeks or more.

**We NEED  
Nominations  
for  
Gardens or  
Porches for the  
2006 Garden  
Walk  
Contact  
Lou Horton  
293-7735**

For the Love of Gardens...



**PLATT HILL  
NURSERY**

Nursery Stock • Perennials • Annuals • Hanging Baskets  
Statues, Fountains & Pottery • Gift Shop • FREE Seminars  
Watergarden Plants & Supplies • Gift Certificates  
Experienced Landscape Designers • Containers  
Christmas Trees & Holiday Decorations

**847-428-6767**

**630-529-9394**

2400 Randall Rd • Carpentersville

222 W. Lake St • Bloomingdale

## Summer flowers

Summer Sale Days... July 22 - August 6

Trees and Shrubs are available all season. Summer plantings will thrive when watered correctly. Pick up an info sheet.

**Water Plants, Roses, Perennials and Annuals**

New plants arrive all summer! Party sizes available!

*Charity Garden Walk... July 8, Tickets \$10.*



**The Growing Place**

Naperville...Plank Rd, 5 blks W of Naper Blvd...630/355-4000

Aurora...Montgomery Rd, 2 blks N of Ogden... 630/820-8088 [thegrowingplace.com](http://thegrowingplace.com)